

NOTE: STARTING IN 2002, PARCEL NUMBERS WILL NOT REFLECT THE TAX MAP NUMBER. PARCEL NUMBERS WILL BE THE 2-DIGIT TOWNSHIP NUMBER.

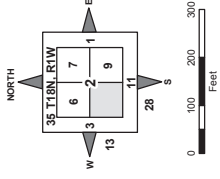

GIS DEPARTMENT  
ROCK ISLAND COUNTY,  
ILLINOIS

FOR SUBDIVISION  
INFORMATION SEE  
SHEET 8-S

SUPERVISORS' ASSESSMENT  
MAP OF  
S.W. 1/4 SECTION 2  
T. 17N., R. 1W. OF 4TH P.M.  
SOUTH MOLINE TOWNSHIP  
SUPPLEMENTAL FOR 2015  
17-03-300  
THIS IS NOT A LEGAL DOCUMENT

